



Northstar[®] Chrysler Pacifica or Voyager

**Side Entry
Power, In-Floor Ramp**
Caregiver | Drive From Wheelchair



Spacious. Safe. Comfortable. Enjoy all this and more from your Vantage Mobility Chrysler Northstar. As an official mobility partner of Chrysler, you can expect everything you love about Chryslers with the ultimate accessibility experience only possible from Vantage Mobility.



Your Personal Parking Guardian

ParkSmart[®]
Advanced sensor systems detects when someone parks too close and sounds a helpful alarm asking them to move



Swap, Drive or Relax on the Go

Interchangeable Seats
Effortlessly switch roles with your travel partner, taking turns at the wheel while leaving constraints in the rearview mirror.



The Industry's #1 Ramp Design

In-Floor Ramp
Smooth and reliable, with the ramp stored under the floor when not in use, everyone enjoys more usable interior space.

Other Customer-Favorite Features



**PowerKneel
Suspension**



**SureDeploy[®]
Ramp Backup**



**Maintenance
Reminders**



**Integrated
FOB**



**Rust
Protection**



Every new Vantage Mobility Wheelchair van conversion is backed by the industry's longest rust-through warranty. **7 years/ Infinite miles.**



360° Access360® Interior Space to Enjoy



DURABLE
Durable Rubber Floor

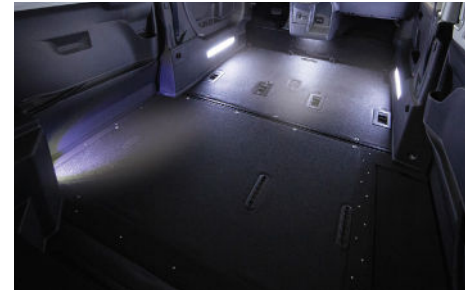

LED Lighting

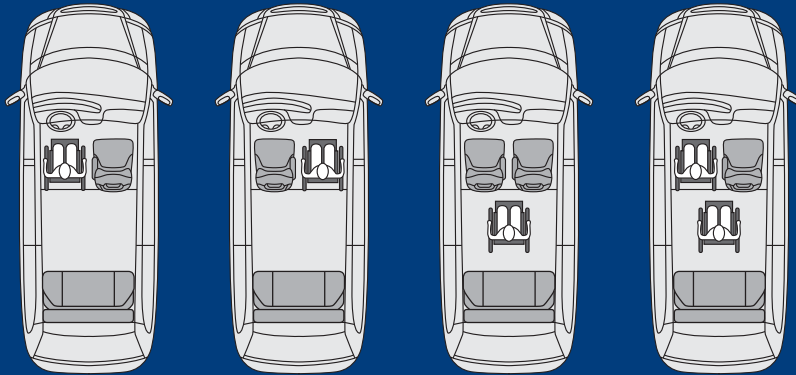

Flexible Seating Options

6 Passenger Capacity

- Multiple seating options for your convenience.
- **Both front seats are interchangeable and/or removable.**
- Drive-From-Wheelchair compatible.

A 56"

Ramp Door Opening Height

B 29.3"

Ramp Door Opening Width

C 30"

Ramp Width

D 9°

Ramp Angle w/ PowerKneel®

E 59"

Interior Headroom

1000LB

Ramp Capacity

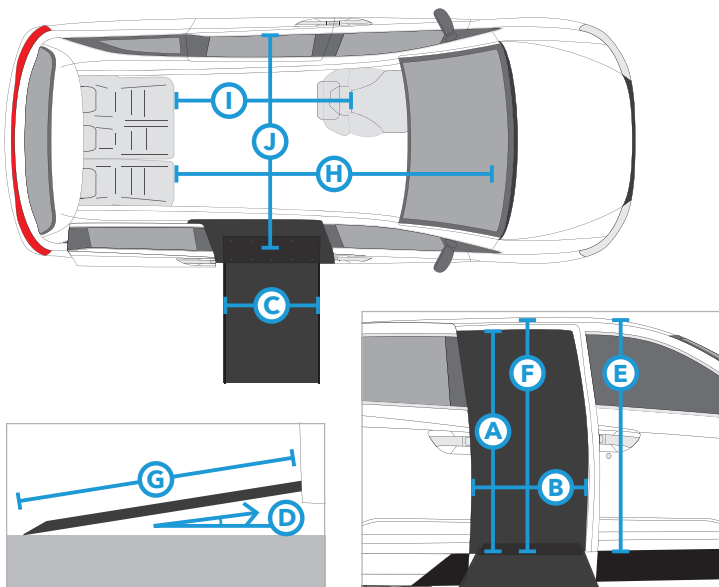

TOYOTA SIENNA HYBRID NORTHSTAR	
F Interior Height at Center Position	59"
G Ramp Length (angled ramp and transition plate)	59"
H Floor Length Overall	91.5"
I Floor Length Behind Front Seats (from B pillar)	65.8"
J Floor Width at Mid-Row	64"
Ground Clearance (Exhaust)	4.6"
Overall Vehicle Height (No Antennae)	74.6"



Seating options may vary. Specifications apply to Vantage Mobility Chrysler Voyager vehicles with a Northstar E conversion. Measurements may vary based on vehicle trim levels and environmental factors. To ensure best vehicle fit, please visit with your local dealer to confirm vehicle measurements prior to purchase. All information is subject to change without notice. © 2023 Vantage Mobility International. All rights reserved.

855-864-8267 • VantageMobility.com • 5202 S 28th Place Phoenix, AZ 85040

